

INSERT



Electrical Requirements

- ✦ We recommend a 15-20 AMP breaker
- ✦ Runs on Standard 110 Volts
- ✦ USA Style Grounded (2x) power plug
- ✦ Can be hardwired into dwelling power source
- ✦ All electrical connections can be made in existing J-Boxes

DO NOT USE POWER STRIPS TO PLUG IN LOG SET

Installation Guide

Mounting inside a wall or
enclosure instructions

ELECTRIC FIREPLACES



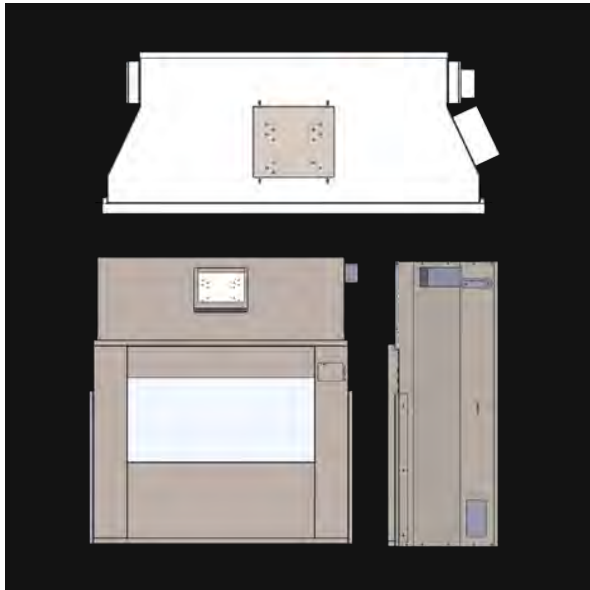

Overall Size

WIDTH: 28.167 in

HEIGHT: 31.723 in

DEPTH: 12.000 in



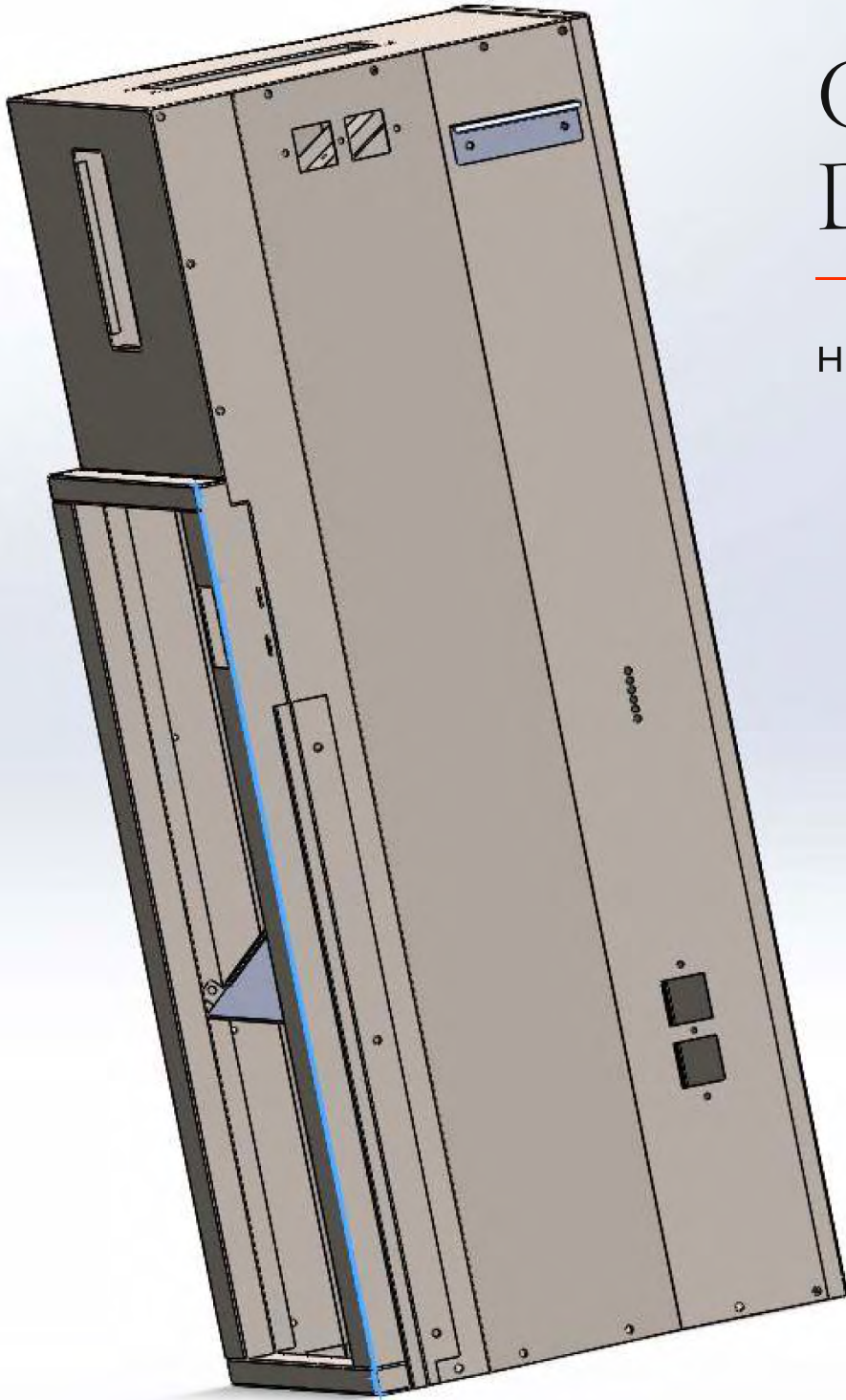

Opening Dimensions

HEIGHT: 22.4671 in

Opening Dimensions

WIDTH: 22.4671 in

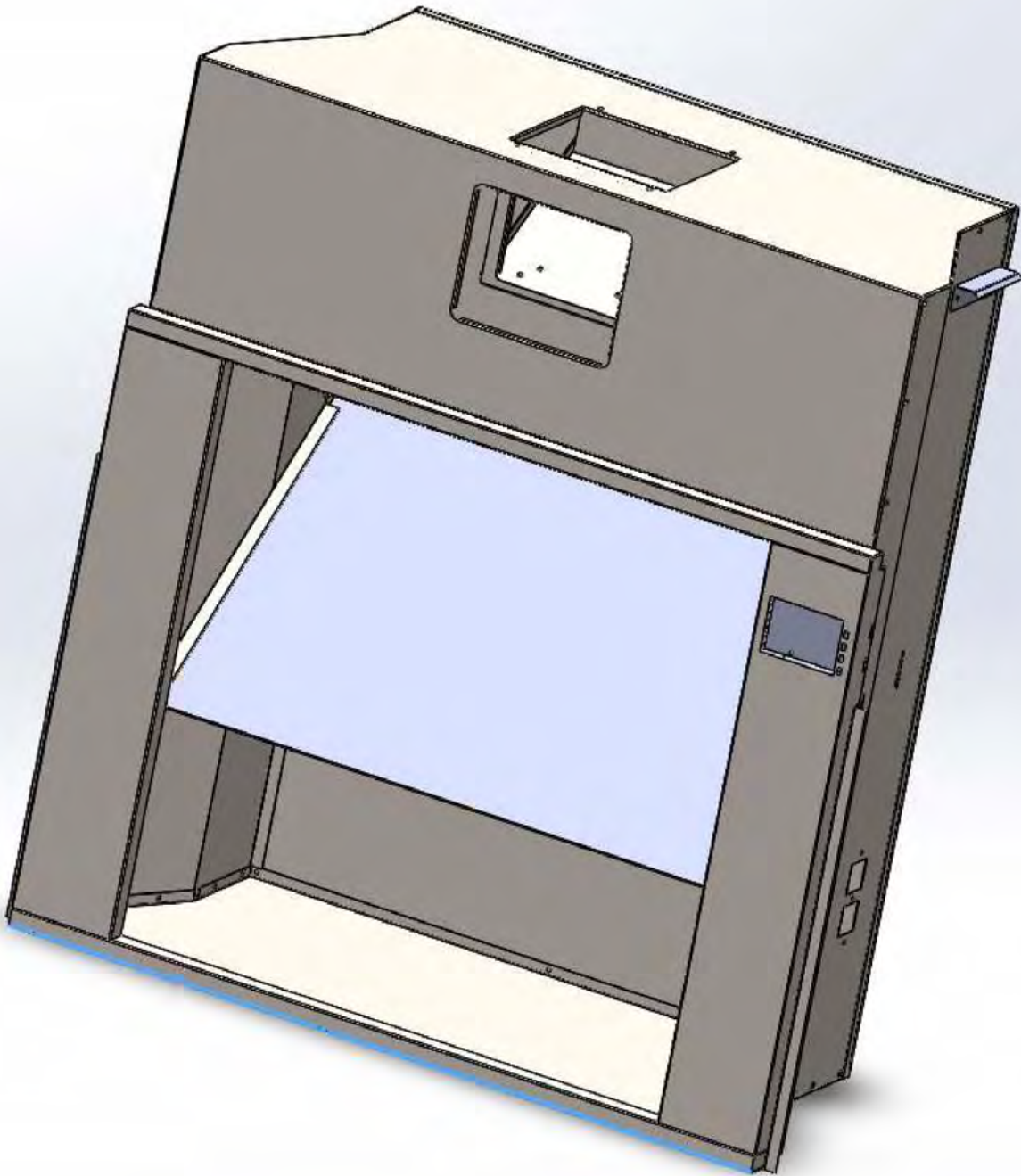

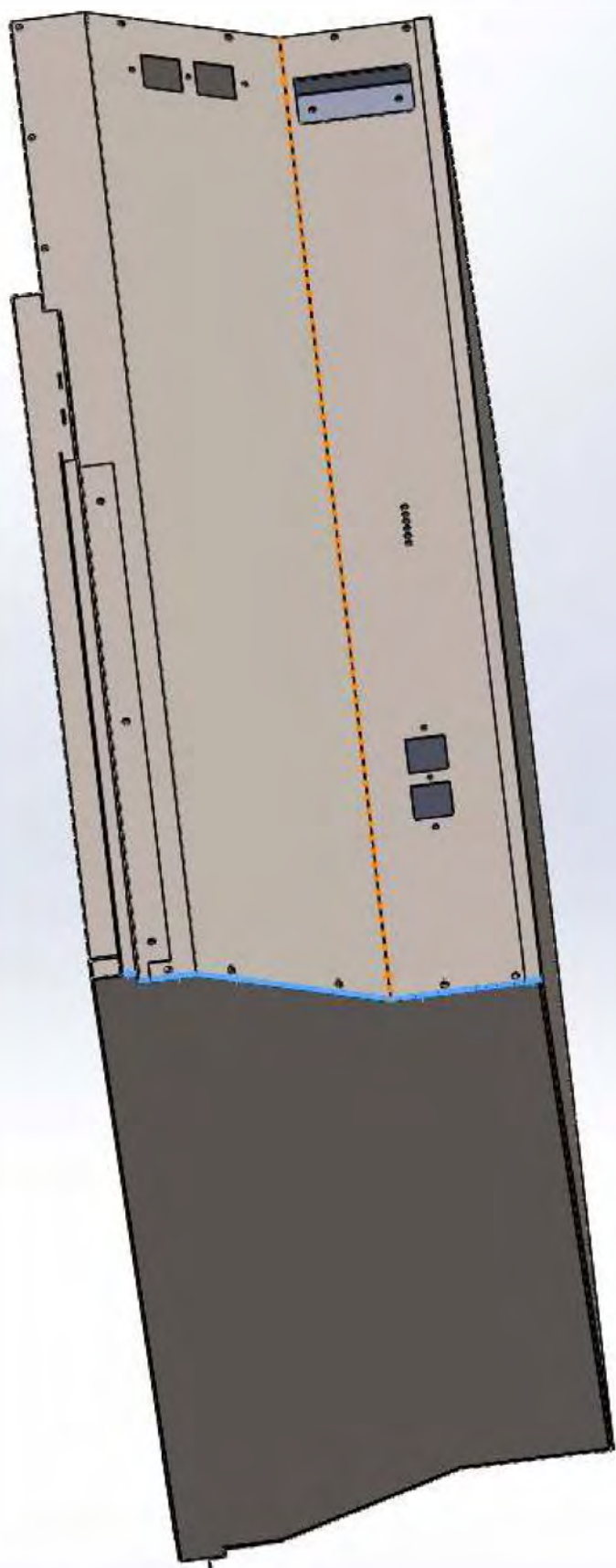

Base Dimensions

DEPTH: 12.000 in

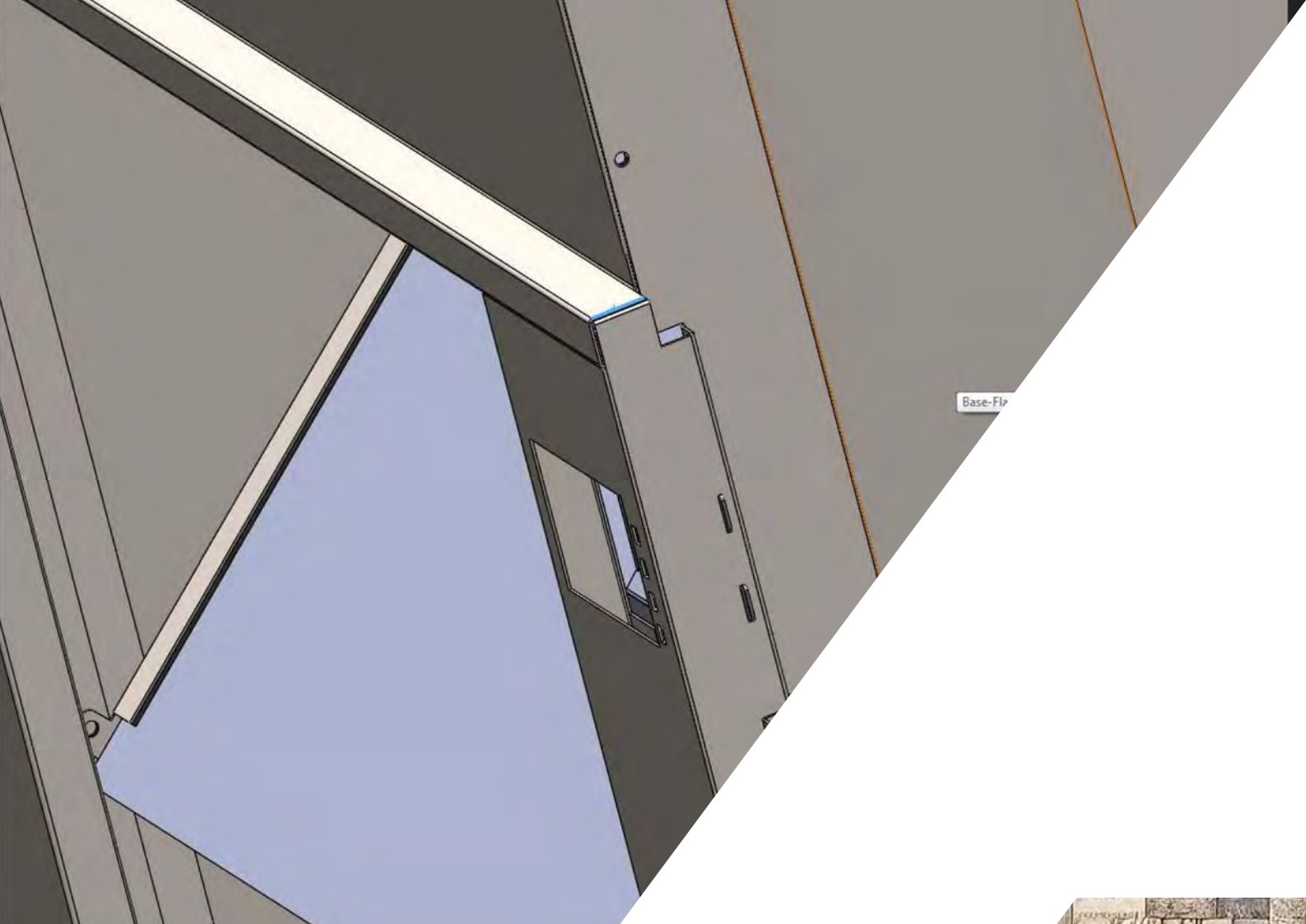

Opening Dimensions

LIP 0.722 in



Hidden Panel Size

Top 9 inches can be sealed in

WIDTH: 27.250 in

HEIGHT: 9.097 in

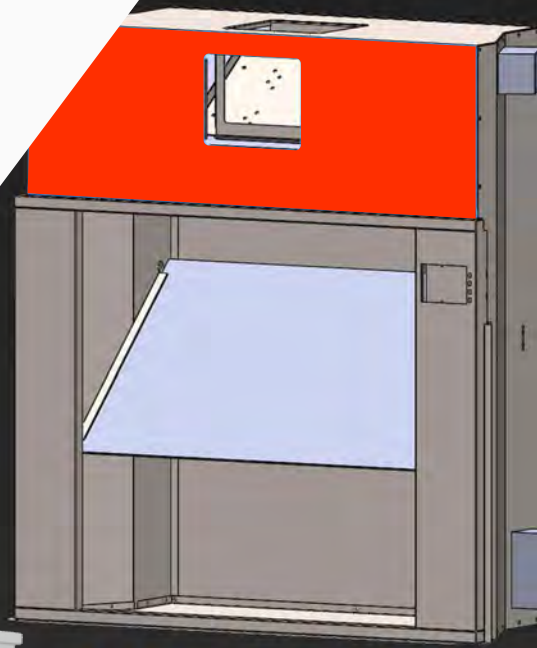

Viewing Hole Size

Slightly increased for margin

WIDTH: 28.160 in

HEIGHT: 22.700 in

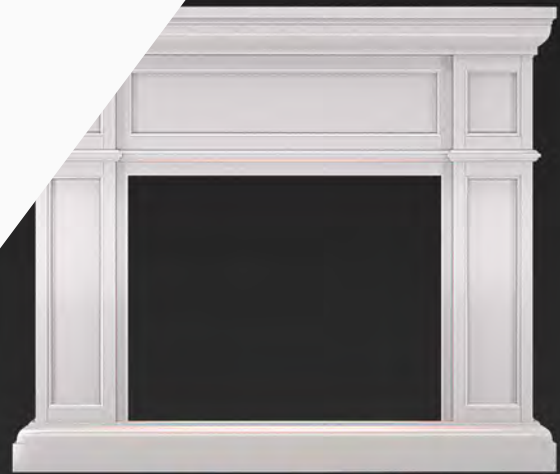

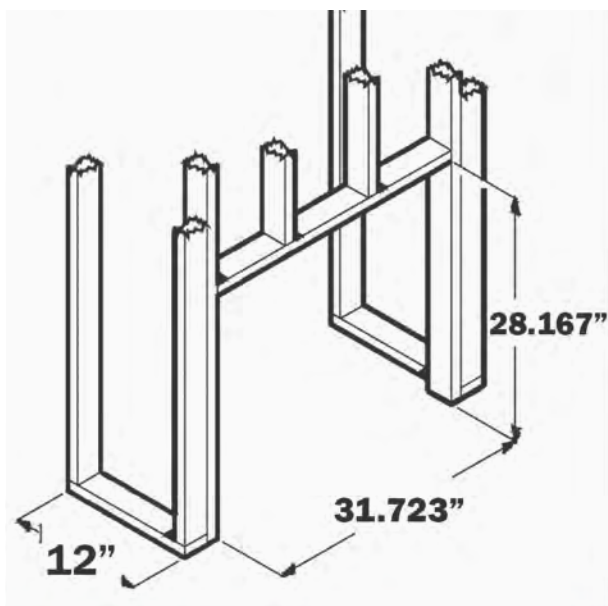

Wall Framing Dims

Create a base for Insert to stand on

WIDTH: 31.723 in

HEIGHT: 28.167 in

DEPTH: 12.000 in





Completed Installations

